

- Design Standard: DIN3352
- Face to Face: DIN3202 F4
- Flange : DIN2501 PN10, PN16
- Testing Conform to DIN3230

- Working Temp: 450°C
- Working Pressure: PN10 , PN16 , PN40
- Suitable Media: Water, Steam, Oil, Acids, Lyes, ect.
- OS&Y, Flexible wedge, Rising stem

Materials

| C | Part Name | Materials | |
|----|---------------|---------------------|---------------|
| 1 | Body | ASTM A126A(B) | CF8M/316 |
| 2 | Seat Ring | ASTM B36/B62, SS410 | AISI316 |
| 3 | Wedge Ring | ASTM B36 | AISI316 |
| 4 | Wedge | ASTM A126A(B) | CF8M/316 |
| 5 | Wedge Nut | ASTM B36 | A194-Gr.8 |
| 6 | Bolt | A216 WCB | GS-C25 |
| 7 | Nut | A216 WCB | A194-Gr.8 |
| 8 | Washer | A216 WCB | GS-C25 |
| 9 | Bonnet Gasket | Graphite/PTFE | Graphite/PTFE |
| 10 | Nut | ASTM B36 | A194-Gr.8 |
| 11 | Half Ring | A216 WCB | GS-C25 |
| 12 | Packing | Graphite | Graphite |
| 13 | Bonnet | ASTM A126A(B) | CF8M/316 |
| 14 | Gland | ASTM B36 | AISI316 |
| 15 | Stem | SS410 | X10Cr13 |
| 16 | Handwheel | ASTM A126B | GGG40.3 |
| 17 | Washer | A216 WCB | GS-C25 |
| 18 | Bolt | A216 WCB | GS-C25 |

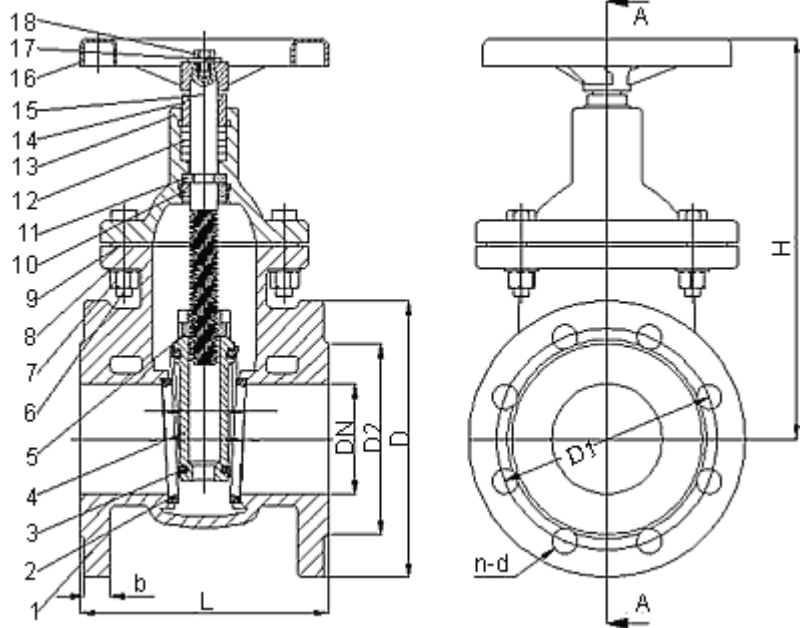

Dimensions

DIN 2501 PN10

| DN | D | D1 | D2 | L | H | b | n | d |
|-----|-----|-----|-----|-----|-----|----|----|----|
| 50 | 165 | 125 | 102 | 150 | 250 | 17 | 4 | 18 |
| 65 | 185 | 145 | 122 | 170 | 265 | 17 | 4 | 18 |
| 80 | 200 | 160 | 138 | 180 | 300 | 19 | 4 | 18 |
| 100 | 220 | 180 | 158 | 190 | 350 | 19 | 8 | 18 |
| 125 | 250 | 210 | 188 | 200 | 410 | 21 | 8 | 18 |
| 150 | 285 | 240 | 212 | 210 | 450 | 21 | 8 | 23 |
| 200 | 340 | 295 | 268 | 230 | 550 | 23 | 8 | 23 |
| 250 | 395 | 350 | 320 | 250 | 650 | 25 | 12 | 23 |
| 300 | 445 | 400 | 370 | 270 | 710 | 25 | 12 | 23 |